

## CR, CRE 5

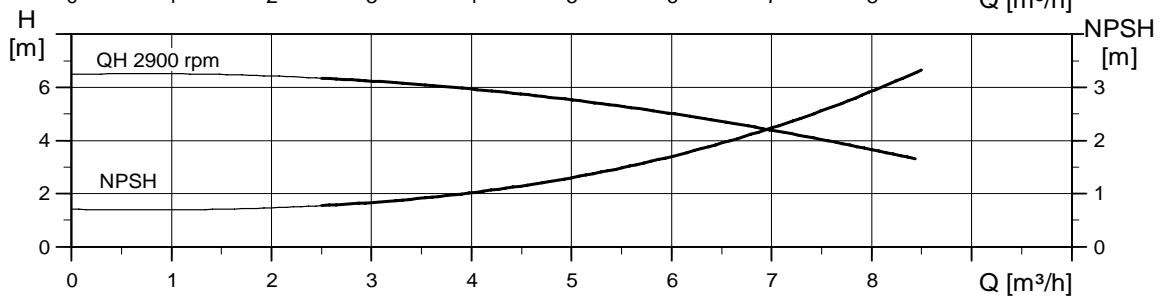

TM02 7294 3605

## Dimensional sketch

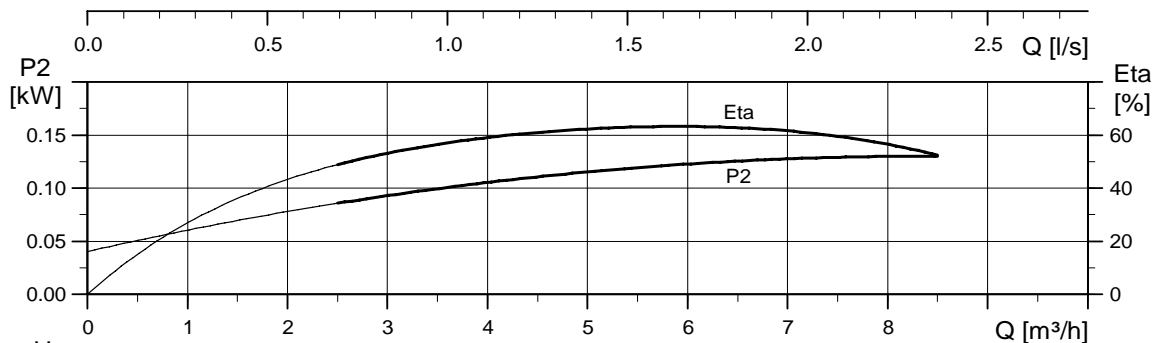
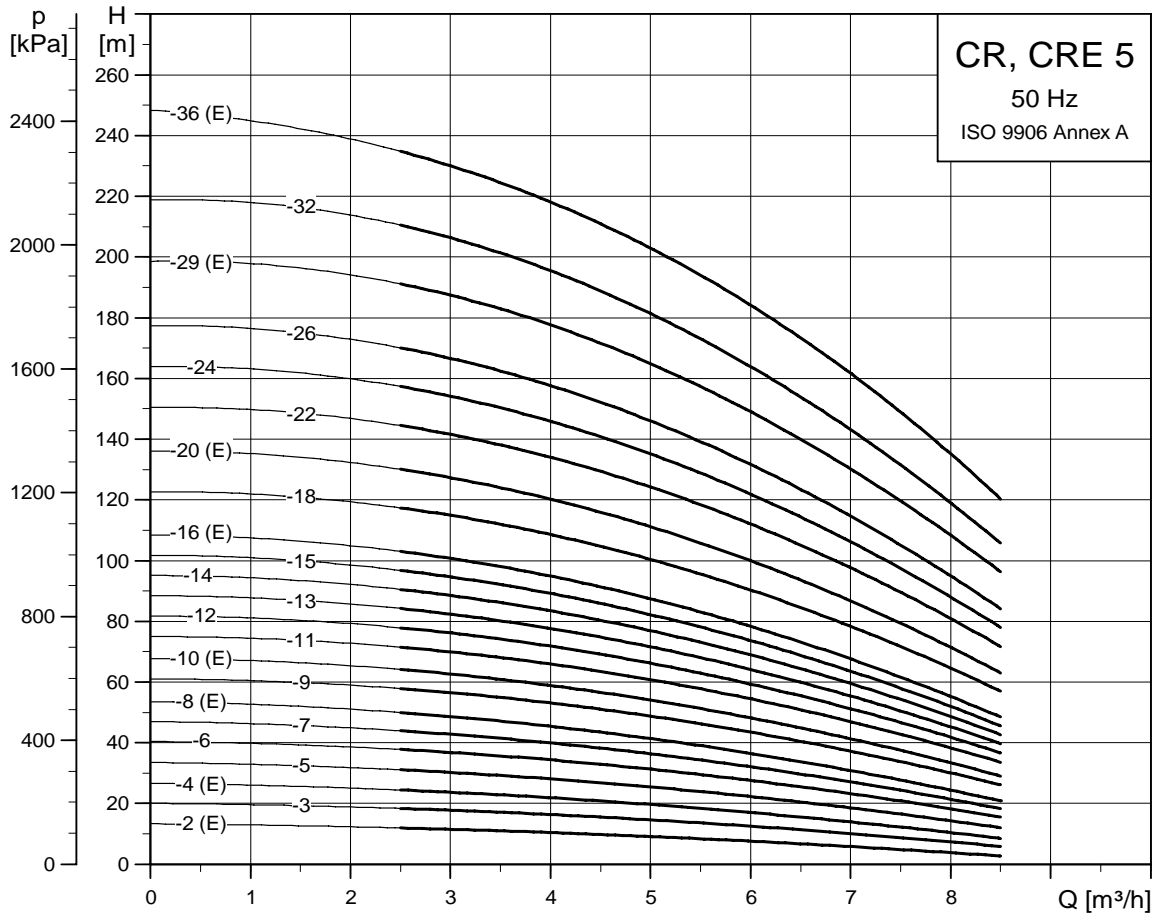
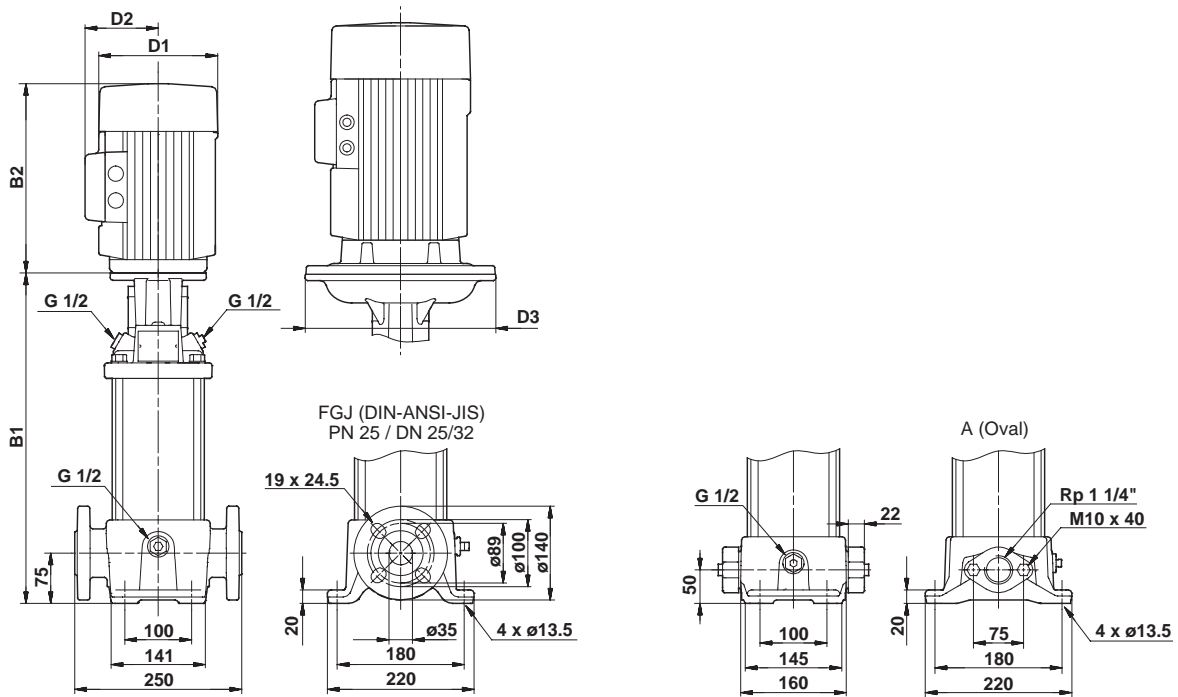

TM03 1723 2805

## Dimensions and weights

Pump type	Motor P <sub>2</sub> [kW]	CR										CRE							
		Dimension [mm]						Net weight [kg]				Dimension [mm]						Net weight [kg]	
		Oval flange		DIN flange		D1	D2	D3	Oval flange	DIN flange	Oval flange		DIN flange		D1	D2	D3	Oval flange	DIN flange
B1	B1+B2	B1	B1+B2							B1	B1+B2	B1	B1+B2						
CR(E) 5-2	0.37	254	445	279	470	141	109	-	18	23	254	445	279	470	141	140	-	19.8	23.9
CR 5-3	0.55	281	472	306	497	141	109	-	20	24	-	-	-	-	-	-	-	-	-
CR(E) 5-4	0.55	308	499	333	524	141	109	-	20	25	308	499	333	524	141	140	-	21.2	25.3
CR 5-5	0.75	341	572	366	597	141	109	-	22	27	-	-	-	-	-	-	-	-	-
CR 5-6	1.1	368	599	393	624	141	109	-	25	30	-	-	-	-	-	-	-	-	-
CR 5-7	1.1	395	626	420	651	141	109	-	26	30	-	-	-	-	-	-	-	-	-
CR(E) 5-8	1.1	422	653	447	678	141	109	-	26	31	422	653	447	678	178	167	-	28.8	32.9
CR 5-9	1.5	465	746	490	771	178	110	-	34	38	-	-	-	-	-	-	-	-	-
CR(E) 5-10	1.5	492	773	517	798	178	110	-	34	39	492	773	517	798	178	167	-	41.3	45.4
CR 5-11	2.2	519	840	544	865	178	110	-	36	40	-	-	-	-	-	-	-	-	-
CR 5-12	2.2	546	867	571	892	178	110	-	36	41	-	-	-	-	-	-	-	-	-
CR 5-13	2.2	573	894	598	919	178	110	-	37	41	-	-	-	-	-	-	-	-	-
CR 5-14	2.2	600	921	625	946	178	110	-	37	42	-	-	-	-	-	-	-	-	-
CR 5-15	2.2	627	948	652	973	178	110	-	38	43	-	-	-	-	-	-	-	-	-
CR(E) 5-16	2.2	654	975	679	1000	178	110	-	38	43	654	975	679	1000	178	167	-	48.5	52.6
CR 5-18	3	712	1047	737	1072	198	120	-	44	48	-	-	-	-	-	-	-	-	-
CR(E) 5-20	3	766	1101	791	1126	198	120	-	45	50	766	1101	791	1126	198	177	-	55.1	59.2
CR 5-22	4	820	1194	845	1217	220	134	-	56	62	-	-	-	-	-	-	-	-	-
CR 5-24	4	-	-	899	1271	220	134	-	-	63	-	-	-	-	-	-	-	-	-
CR 5-26	4	-	-	953	1325	220	134	-	-	64	-	-	-	-	-	-	-	-	-
CR(E) 5-29	4	-	-	1034	1406	220	134	-	-	66	-	-	1034	1406	220	188	-	-	76.5
CR 5-32	5.5	-	-	1145	1536	220	134	300	-	82	-	-	-	-	-	-	-	-	-
CR(E) 5-36	5.5	-	-	1253	1644	220	134	300	-	84	-	-	1253	1644	220	188	-	-	95.5